

page 293

© Crown copyright and database rights 2014, Ordnance Survey, 100019259.

This map is based on Ordnance Survey material with the permission of Ordnance Survey on behalf of HMSO. Unauthorised reproduction infringes Crown Copyright and may lead to prosecution or Civil proceedings. London Borough of Merton 100019259, 2012.

DEVELOPMENT CONTROL

Kings College
Southside Common

Scale 1/2500
Date 10/3/2015

London Borough of Merton
100 London Road
Morden
Surrey
SM4 5DX



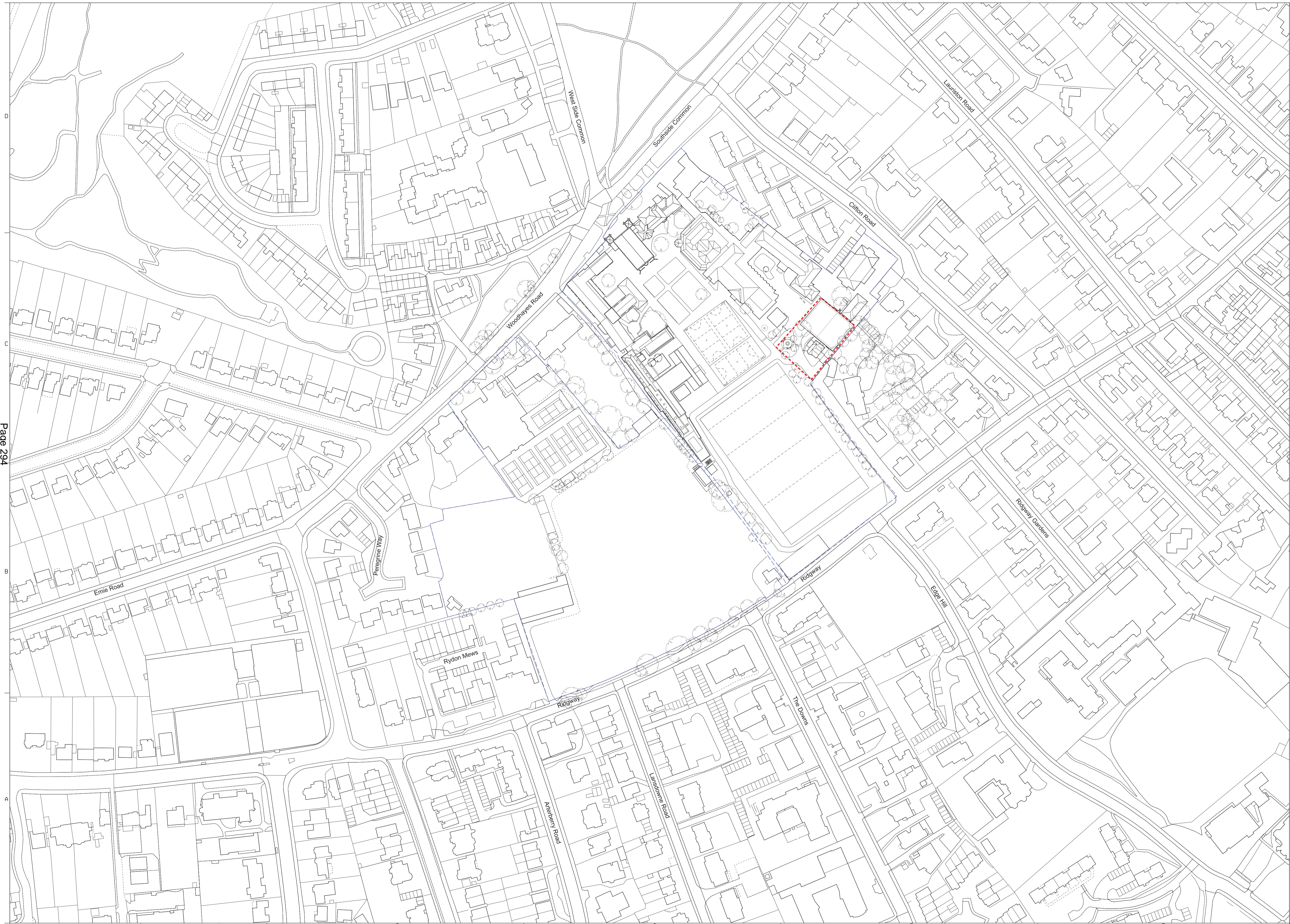

Page 294

- General Notes:**
- G1 For Site and Grid setting out refer to AKSCW/3000
 - G2 All dimensions to be checked on site
 - G3 Any discrepancies between drawings to be reported to the Architect immediately.
 - G4 All Levels are above ordnance datum (AOD)
 New Levels are shown thus: 20.345
 Existing Levels are shown thus: 20.345
 Retained Existing Levels: EX-20.345
 - G5 Use figured dimensions only. Do not scale from drawings. IF IN DOUBT, ASK.
 - G6 Refer to Structural Engineers drawings for all structural and services information.
 - G7 For tolerances see the Design Drawings and Specifications
 - G8 For elements of work subject to Contractor's Design, this drawing is indicative of the visual & performance requirements only. The Contractor is responsible for the detailed design and coordination of the installation within the parameters defined in the specification, design drawings, contract terms and contract documents.
 - G9 Room numbers are shown thus: 115
 - G10 Door(D) & Window (W) References are shown thus: D1
 - G11 Clear height is shown thus (finished floor to finished soffit) 2150
 - G12 T Sheet Reference shown thus RWS-01
 - G13 Finishes are shown thus: SOP
 - G14 Setting Out Points shown thus: SOP
 - G15 Refer to AKCSW/100 for T Sheet references, and to AKCSW/102 for Architectural Specifications.

- Key**
- - - School Boundary line
 - - - Site Boundary line

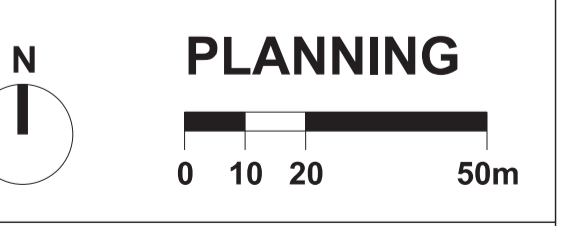

Work Package	Cost Check	Info/Briefing	Tender	Contract	Construction

Date	Ref.	Revision	Approved by
15.11.2013		Issued under IN 001 for Pre Planning Application	SJ
02.12.2013	B	Issued under IN 002 for Pre Planning Application supplementary note	SJ
30.05.2014	C	Issued under Memo 018 - Draft Planning for Design Team	AS
15.12.2014	D	Stage C Drawings	AS
16.12.2014	E	Issued under Memo 029 for Planning Application	SJ

Date	Ref.	Revision

Project King's College School Wimbledon, Music School
 Subject Site Location Plan
 Architects Hopkins Architects Partnership LLP
 27 Broadley Terrace, London, NW1 6LG
 T: 020 7724 1751 E: mail@hopkins.co.uk

Sort Code	Drawing Number	Rev.
AKCSW	0001	E

Date 15.11.2013 Scale 1:1250 at A1



01 Existing Plan
A0100 1:500

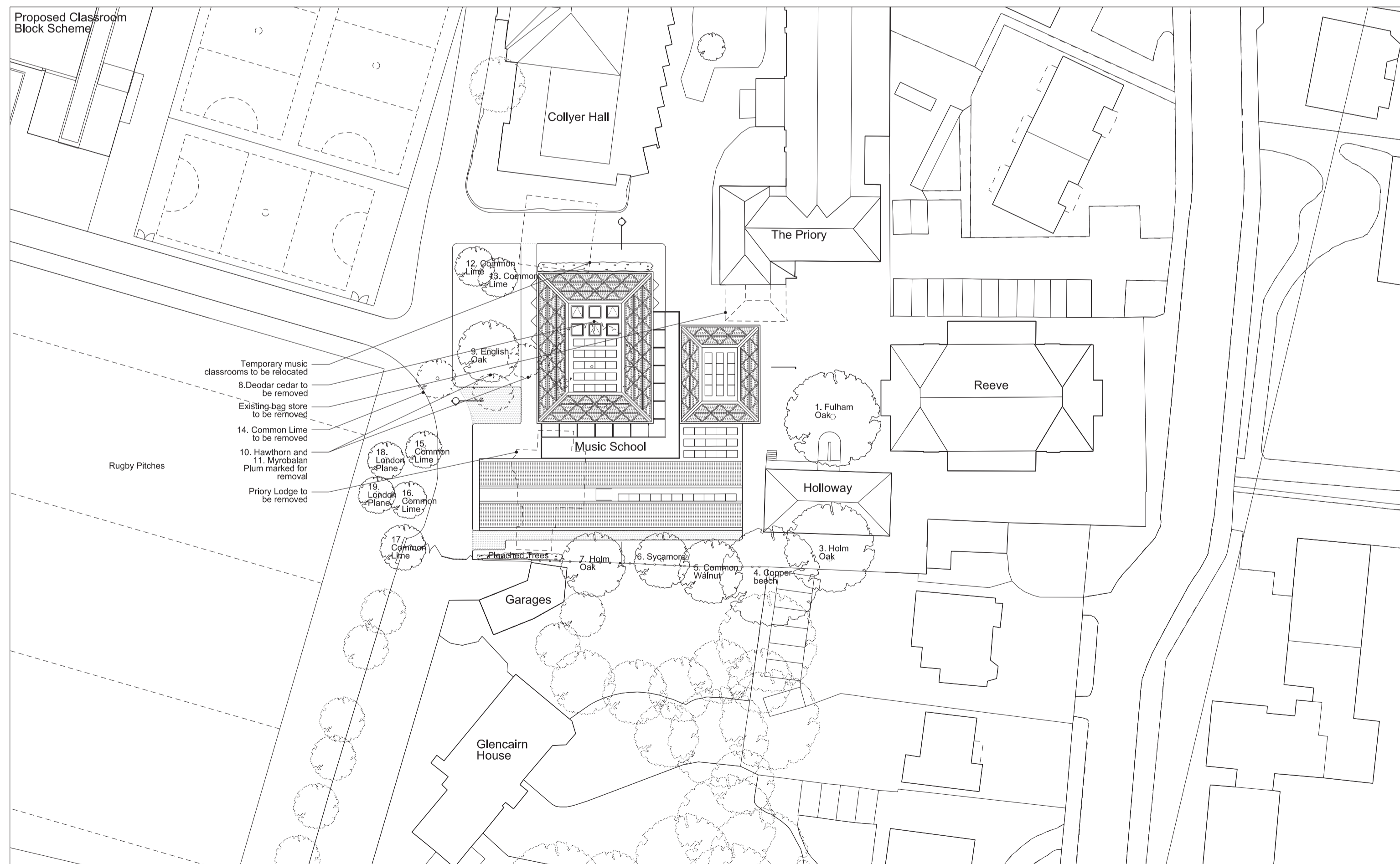

02 Proposed Plan
A0100 1:500

General Notes:

- G1 For Site and Grid setting out refer to AKCSW/3000
- G2 All dimensions to be checked on site
- G3 Any discrepancies between drawings to be reported to the Architect immediately.
- G4 All Levels are above ordnance datum (AOD)
New Levels are shown thus: D00.345
Existing Levels are shown thus: EX-00.345
Retained Existing Levels: EX-20.345
- G5 Use figured dimensions only. Do not scale from drawings. IF IN DOUBT, ASK.
- G6 Refer to Structural Engineers drawings for all structural and services information.
- G7 For tolerances see the Design Drawings and Specifications
- G8 For elements of work subject to Contractor's Design, this drawing is indicative of the visual & performance requirements only. The Contractor is responsible for the detailed design and co-ordination of the installation within the parameters defined in the specification, design drawings, contract terms and contract documents.
- G9 Room numbers are shown thus: 115
- G10 Door(D) & Window (W) References are shown thus: D115
- G11 Clear height is shown thus (finished floor to finished soffit) 2750
- G12 T Sheet Reference shown thus TWS-01
- G13 Finishes are shown thus: SOP
- G14 Setting Out Points shown thus: SOP
- G15 Refer to AKCSW/9100 for T Sheet references, and to AKCSW/9102 for Architectural Specifications.

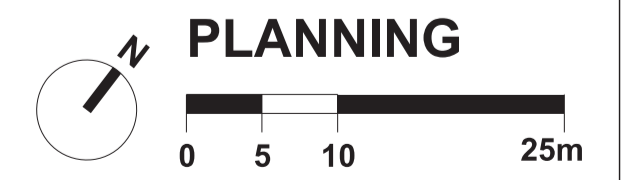
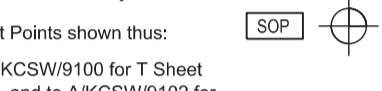
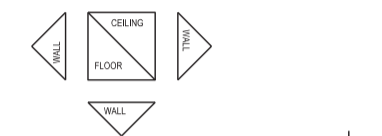

PLANNING

Work Package	Cost Check	Info/Briefing	Tender	Contract	Construction

Date	Ref.	Revision	Approved by	Date	Ref.	Revision
16.12.2014	-	Issued under Memo 029 for Planning Application	SJ			

Project	King's College School Wimbledon, Music School
Subject	Existing and Proposed Block Plans
Architects	Hopkins Architects Partnership LLP 27 Broadley Terrace, London, NW1 6LG T: 020 7724 1751 E: mail@hopkins.co.uk

Sort Code	Drawing Number	Rev.
A/KCSW	0100	-
Date	30.05.2014	Scale 1:500 at A1

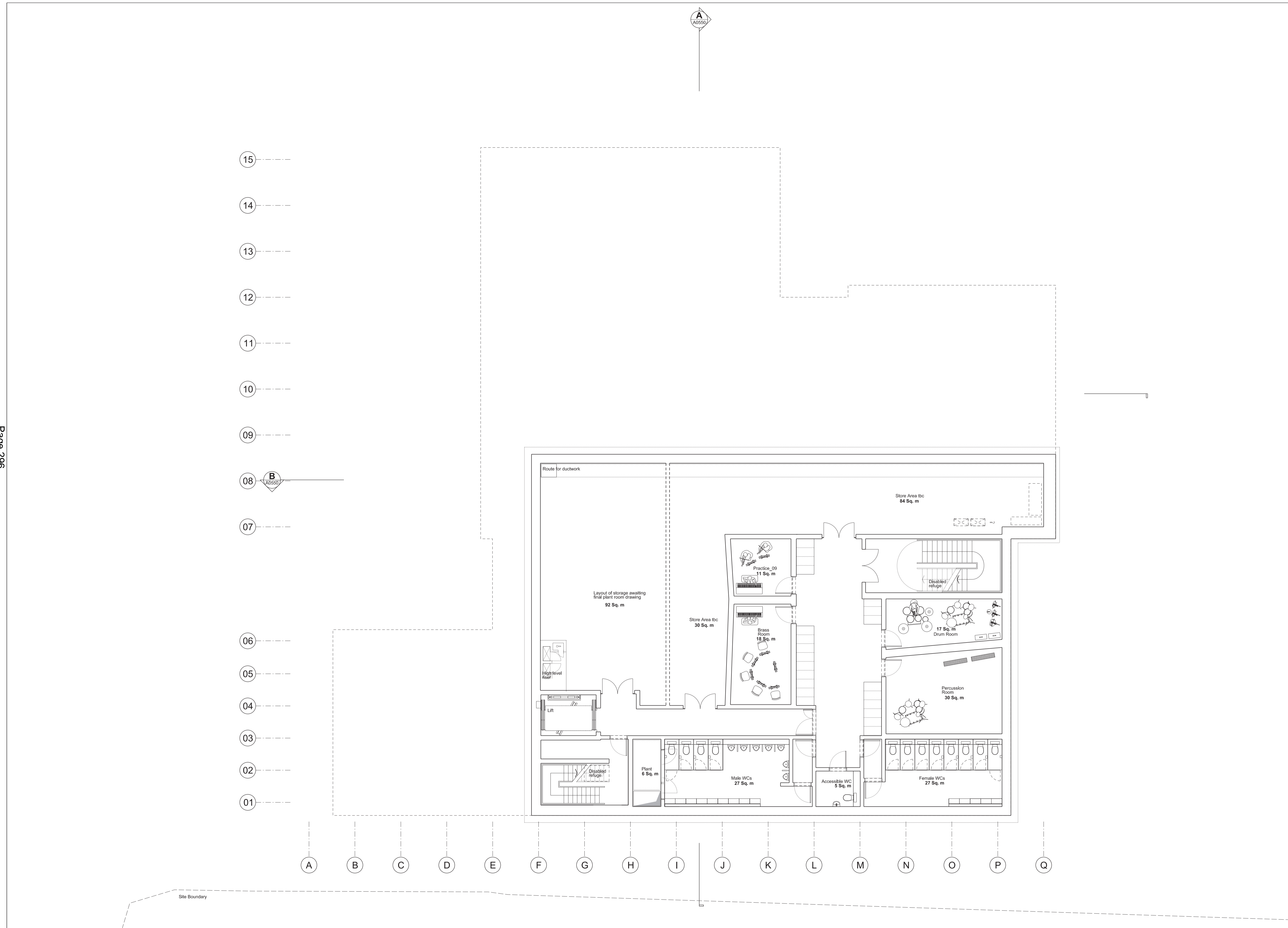

- General Notes:**
- G1 For Site and Grid setting out refer to AKCSW/3000
 - G2 All dimensions to be checked on site
 - G3 Any discrepancies between drawings to be reported to the Architect immediately.
 - G4 All Levels are above ordnance datum (AOD)
 New Levels are shown thus: D20.345
 Existing Levels are shown thus: EX-20.345
 Retained Existing Levels: EX-20.345
 - G5 Use figured dimensions only. Do not scale from drawings. IF IN DOUBT, ASK.
 - G6 Refer to Structural Engineers drawings for all structural and services information.
 - G7 For tolerances see the Design Drawings and Specifications
 - G8 For elements of work subject to Contractor's Design, this drawing is indicative of the visual & performance requirements only. The Contractor is responsible for the detailed design and co-ordination of the installation within the parameters defined in the specification, design drawings, contract terms and contract documents.
 - G9 Room numbers are shown thus: 115
 - G10 Door(D) & Window (W) References are shown thus: D1
 - G11 Clear height is shown thus (finished floor to finished soffit) 2750
 - G12 T Sheet Reference shown thus INS-01
 - G13 Finishes are shown thus:
 - G14 Setting Out Points shown thus: SOP
 - G15 Refer to AKCSW/100 for T Sheet references, and to AKCSW/102 for Architectural Specifications.

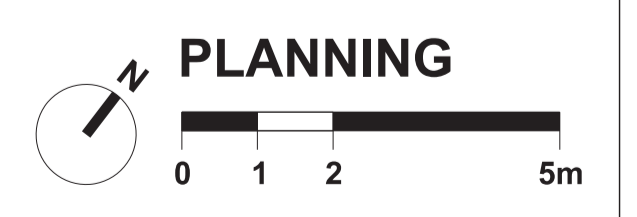

Work Package	Cost Check	Info/Briefing	Tender	Contract	Construction

Date	Ref.	Revision	Approved by
16.12.2014	-	Issued under Memo 029 for Planning Application	SJ

Date	Ref.	Revision

Project King's College School Wimbledon, Music School
 Subject Basement Plan
 Architects Hopkins Architects Partnership LLP
 27 Broadley Terrace, London, NW1 6LG
 T: 020 7724 1751 E: mail@hopkins.co.uk

Sort Code	Drawing Number	Rev.
A/KCSW	0400	-

Date 30.05.2014 Scale 1:100 at A1