

DRAWING REGISTER

ISSUE DATE	17.08.18																	
	20.02.19																	
	08.08.19																	

01	SITE LOCATION PLANS	A	B	C														
02	SITE PLAN	A	B	C														
03	PROPOSED SITE ELEVATION	A	B	C														
04	PROPOSED EQUIPMENT LAYOUT	A	B	C														
05	PROPOSED ANTENNA AND DISH LAYOUT	A	B	C														

Page 197

DRAWING STATUS

PLANNING ISSUE	X	X	X															
DETAIL DESIGN ISSUE	-	-	-															
AS BUILT ISSUE	-	-	-															

DISTRIBUTION

E - ELECTRONIC COPY

SHARED ACCESS	A	B	C															
SHIRE	-	-	C															

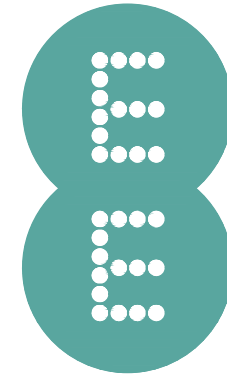

shared access

EE ID: 78203

RAYNES PARK SPORTS GROUND

TAUNTON AVENUE
RAYNES PARK
WEST WIMBLEDON
LONDON
SW20 0BH

LEGAL GAD

THESE DRAWINGS COMPLY WITH STANDARD ICNIRP DESIGN GUIDELINES.

GENERAL NOTES:

- 1.1) USE WRITTEN DIMENSIONS ONLY
- 1.2) ALL DIMENSIONS ARE IN MM UNLESS SPECIFIED
- 1.3) ASSUME ALL SITE DETAILS ARE EXISTING UNLESS SPECIFIED

DEPENDENCIES	
CHERRY PICKER SURVEY	NO
STAT SEARCH	YES
TRIAL DIG	NO
GEOTECH	YES
GDC	NO
BOLT PULL-OUT TEST	NO
STRUCTURAL CALCULATIONS	NO
BUILDING REGULATIONS	NO
ELECTRICAL LOAD TEST	NO
REC SERVICE ALTERATION	NO
COMMS SERVICE ALTERATION	NO
ASBESTOS SURVEY	NO
ANTENNA TESTING	NO
COOLING CALCULATIONS	NO

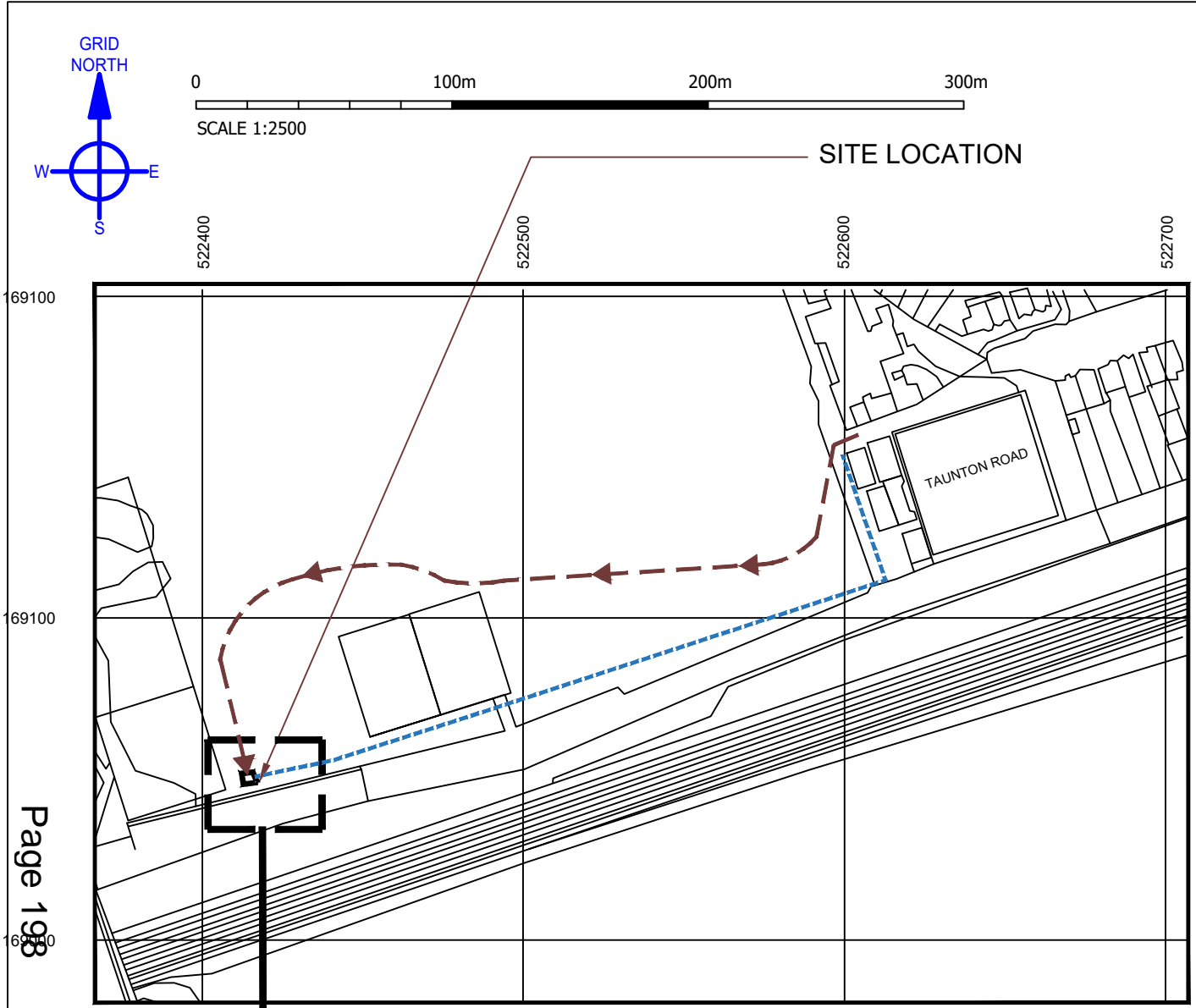

SITE LOCATION (SCALE 1:2500)

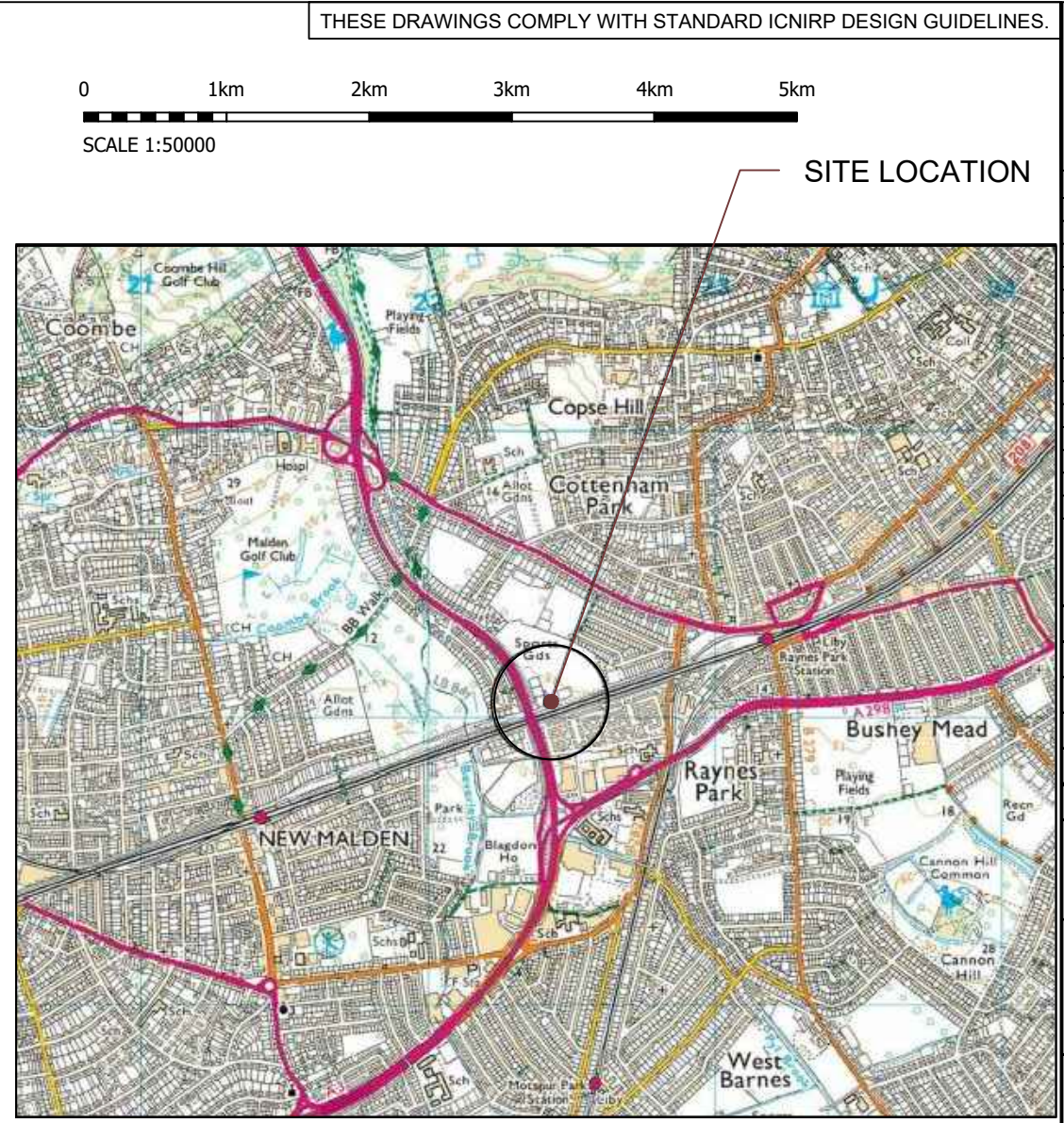

SITE LOCATION (SCALE 1:50000)

Page 198

DETAILED SITE LOCATION PLAN

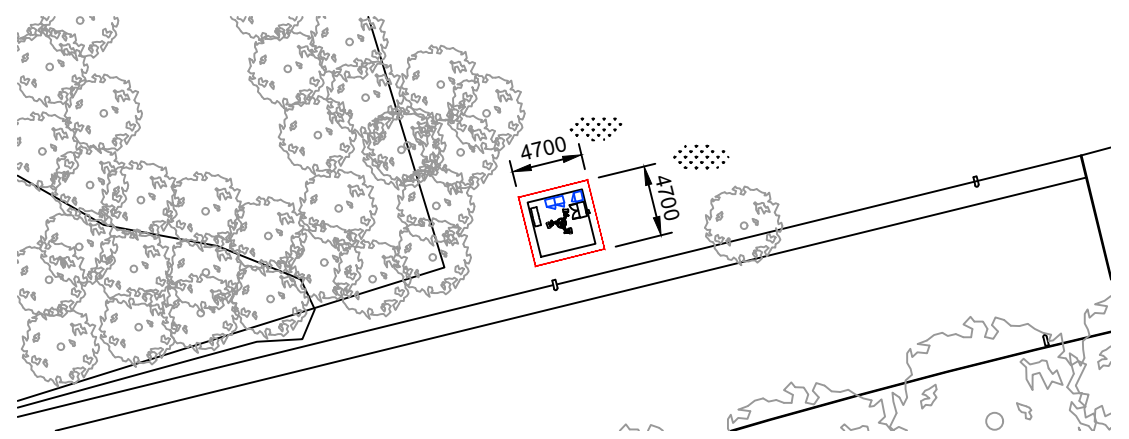

DETAILED SITE LOCATION PLAN (SCALE 1:500)

	SITE ACCESS
	PUBLIC HIGHWAY
	POWER ROUTE (INDICATIVE)

DIRECTIONS TO SITE:
HEADING EAST ON M4
 AT END OF M4 CONTINUE ONTO A4. AFTER 1.1 MILES AT ROUNDABOUT TAKE 2ND EXIT. AFTER 1.0 MILE TAKE SLIPROAD LEFT. AFTER 0.2 MILE KEEP LEFT ON TO A306 (HAMMERSMITH BRIDGE ROAD). AFTER 1.2 MILES KEEP LEFT TO STAY ON A306 (ROCKS LANE). AFTER 2.4 MILES TURN RIGHT ONTO A3 (KINGSTON ROAD). TAKE SLIPROAD LEFT AFTER 2.5 MILES. AFTER 0.8 MILE TURN RIGHT ONTO B282 (WEST BARNES LANE). TURN RIGHT ONTO TAUNTON LANE. AT BEND IN ROAD CONTINUE ON INTO RAYNES PARK SPORTS GROUND. BEAR LEFT PAST PAVILION AND FOLLOW ROAD AROUND TO SOUTH-WEST CORNER OF SPORTS FIELD. SITE IS LOCATED ADJACENT TO UNMADE TRACK AREA.

REV	ISSUE	DATE	DRN	APP
C	LEGAL UPDATE	08.08.19	LN	MH
B	GENERAL AMENDMENTS	20.02.19	GB	GD
A	FIRST ISSUE	17.08.18	GB	GD

THIS DRAWING IS THE COPYRIGHT OF NET COVERAGE SOLUTIONS LTD AND MAY NOT BE REPRODUCED OR DISCLOSED TO A THIRD PARTY IN ANY FORM WITHOUT WRITTEN PERMISSION

Shire
 Head Office:
 The Chapel, Barnsley Hall Road,
 Bromsgrove, Worcestershire,
 B61 0SZ
 Tel: +44 (0) 1527 579 933
 Email: info@shire-uk.com

shared access



OPERATOR REF NO. TM:78203

OPERATOR: EE

DRAWING TITLE: SITE LOCATION PLANS

SCALE: AS SHOWN

SITE NO. 78203

SITE NAME: RAYNES PARK SPORTS GROUND

SITE ADDRESS: TAUNTON AVENUE
 RAYNES PARK
 WEST WIMBLEDON
 LONDON SW20 0BH

OS GRID REFERENCE:
 522415/169050

DRAWN: GB CHK: JL APP: GD

DATE: 25.06.19

SITE NO.	OPERATOR	DRG NO.	REVISION
78203	- EE -	01 -	C

ORIGINAL DRAWING SIZE: A3

ALL MAPS OBTAINED VIA PROMAP.
 ORDNANCE SURVEY © CROWN COPYRIGHT 2019.
 ALL RIGHTS RESERVED. LICENCE NUMBER 100022432.

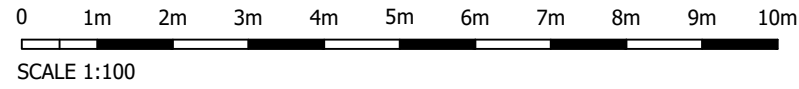
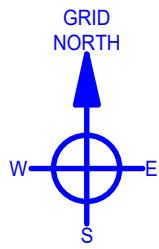

INFRASTRUCTURE KEY:

- OPERATOR INSTALLATION
- SHARED ACCESS INFRASTRUCTURE
- THE MAST
- THE SITE
- THE PLINTH
- ACCESS ROUTE

GENERAL NOTES:

1.1) USE WRITTEN DIMENSIONS ONLY
 1.2) ALL DIMENSIONS ARE IN MM UNLESS SPECIFIED
 1.3) ASSUME ALL SITE DETAILS ARE EXISTING UNLESS SPECIFIED

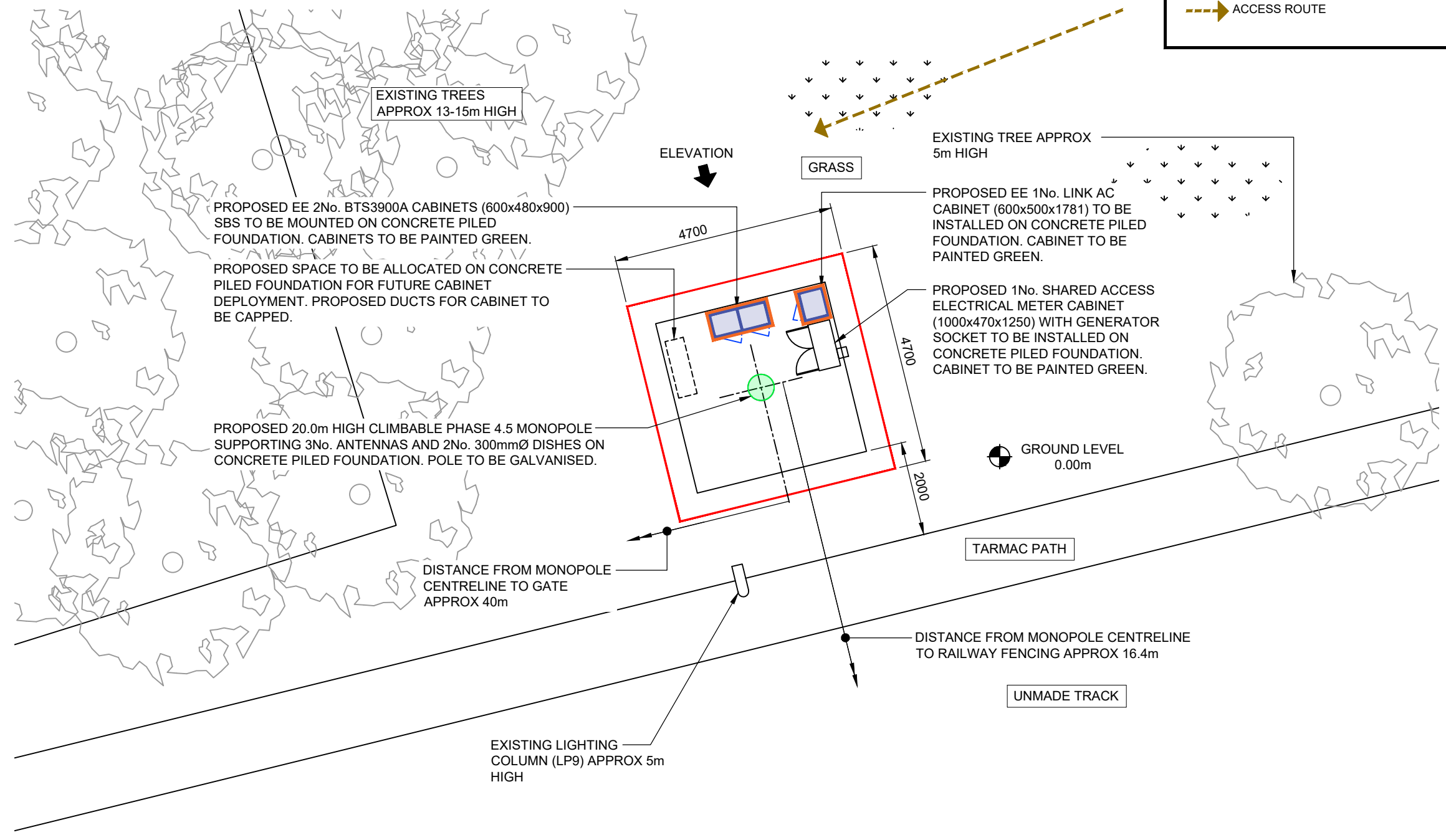

Page 199

SITE PLAN (SCALE 1:100)

REV	ISSUE	DATE	DRN	APP
C	LEGAL UPDATE	25.06.19	BF	MNH
B	GENERAL AMENDMENTS	20.02.19	GB	GD
A	FIRST ISSUE	17.08.18	GB	GD

© THIS DRAWING IS THE COPYRIGHT OF NET COVERAGE SOLUTIONS LTD AND MAY NOT BE REPRODUCED OR DISCLOSED TO A THIRD PARTY IN ANY FORM WITHOUT WRITTEN PERMISSION

Shire

Head Office:
 The Chapel, Barnsley Hall Road,
 Bromsgrove, Worcestershire,
 B61 0SZ
 Tel: +44 (0) 1527 579 933
 Email: info@shire-uk.com

shared access



OPERATOR REF NO. TM:78203

OPERATOR: EE

DRAWING TITLE: SITE PLAN

SCALE: 1:100

SITE NO. 78203

SITE NAME: RAYNES PARK SPORTS GROUND

SITE ADDRESS: TAUNTON AVENUE
 RAYNES PARK
 WEST WIMBLEDON
 LONDON SW20 0BH

OS GRID REFERENCE:
 522415/169050

DRAWN: GB CHK: JL APP: GD

DATE: 17.08.18

SITE NO.	OPERATOR	DRG NO.	REVISION
78203	- EE -	02 -	C

ORIGINAL DRAWING SIZE: A3

0 1m 2m 3m 4m 5m 6m 7m 8m 9m 10m

SCALE 1:100

INFRASTRUCTURE KEY:

- OPERATOR INSTALLATION
- SHARED ACCESS INFRASTRUCTURE

GENERAL NOTES:

- 1.1) USE WRITTEN DIMENSIONS ONLY
- 1.2) ALL DIMENSIONS ARE IN MM UNLESS SPECIFIED
- 1.3) ASSUME ALL SITE DETAILS ARE EXISTING UNLESS SPECIFIED

PROPOSED 9No. MHA'S TO BE MOUNTED TO ANTENNA POLES

TOP OF ANTENNAS
▽ +20.00m AGL

CENTRE OF DISHES
▽ +16.00m AGL

APPROX EXISTING TREES HEIGHT
▽ +15.00m AGL

PROPOSED 20.0m HIGH CLIMBABLE PHASE 4.5 MONOPOLE SUPPORTING 3No. ANTENNAS AND 2No. 300mmØ DISHES ON CONCRETE PILED FOUNDATION. POLE TO BE GALVANISED.

INDICATIVE OPERATOR FEEDERS

APPROX EXISTING TREES HEIGHT
▽ +10.00m AGL

PROPOSED EE 1No. LINK AC CABINET (600x500x1781) TO BE MOUNTED ON CONCRETE PILED FOUNDATION. 1No. SHARED ACCESS ELECTRICAL METER CABINET (1000x470x1250) CABINET LOCATED BEHIND EE 1No. LINK AC HENCE HIDDEN FROM VIEW. CABINETS TO BE PAINTED GREEN.

EXISTING 5m HIGH LIGHTING COLUMN (LP9)

NOTE: PROPOSED SPACE TO BE ALLOCATED ON CONCRETE PILED FOUNDATION FOR FUTURE CABINET DEPLOYMENT. PROPOSED DUCTS FOR CABINET TO BE CAPPED.

EXISTING 2.4m HIGH PALISADE FENCING

EXISTING TREE APPROX 5m HIGH

0.00m GL

PROPOSED EE 2No. BTS3900A CABINETS (600x480x900) SBS TO BE MOUNTED ON CONCRETE PILED FOUNDATION. CABINETS TO BE PAINTED GREEN.

PROPOSED SITE ELEVATION (SCALE 1:100)

Page 200

C	LEGAL UPDATE	08.08.19	LN	MH
B	GENERAL AMENDMENTS	20.02.19	GB	GD
A	FIRST ISSUE	17.08.18	GB	GD
REV	ISSUE	DATE	DRN	APP

© THIS DRAWING IS THE COPYRIGHT OF NET COVERAGE SOLUTIONS LTD AND MAY NOT BE REPRODUCED OR DISCLOSED TO A THIRD PARTY IN ANY FORM WITHOUT WRITTEN PERMISSION

Shire
Head Office:
The Chapel, Barnsley Hall Road,
Bromsgrove, Worcestershire,
B61 0SZ
Tel: +44 (0) 1527 579 933
Email: info@shire-uk.com

shared access



OPERATOR REF NO. TM:78203

OPERATOR: EE

DRAWING TITLE: PROPOSED SITE ELEVATION

SCALE: 1:100

SITE NO. 78203

SITE NAME: RAYNES PARK SPORTS GROUND

SITE ADDRESS: TAUNTON AVENUE
RAYNES PARK
WEST WIMBLEDON
LONDON SW20 0BH

OS GRID REFERENCE:
522415/169050

DRAWN: GB CHK: JL APP: GD

DATE: 17.08.18

SITE NO.	OPERATOR	DRG NO.	REVISION
78203	- EE -	03	- C

ORIGINAL DRAWING SIZE: A3

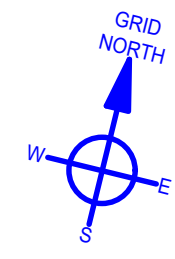
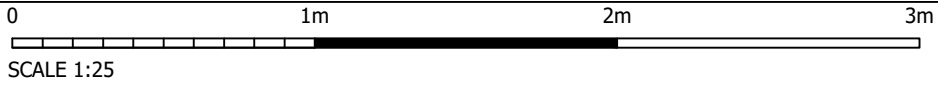

GENERAL NOTES:
 1.1) USE WRITTEN DIMENSIONS ONLY
 1.2) ALL DIMENSIONS ARE IN MM UNLESS SPECIFIED
 1.3) ASSUME ALL SITE DETAILS ARE EXISTING UNLESS SPECIFIED

INFRASTRUCTURE KEY:
 OPERATOR INSTALLATION
 SHARED ACCESS INFRASTRUCTURE
 THE SITE

NOTE: ALL UNUSED DUCTS TO BE LEFT POT-ENDED

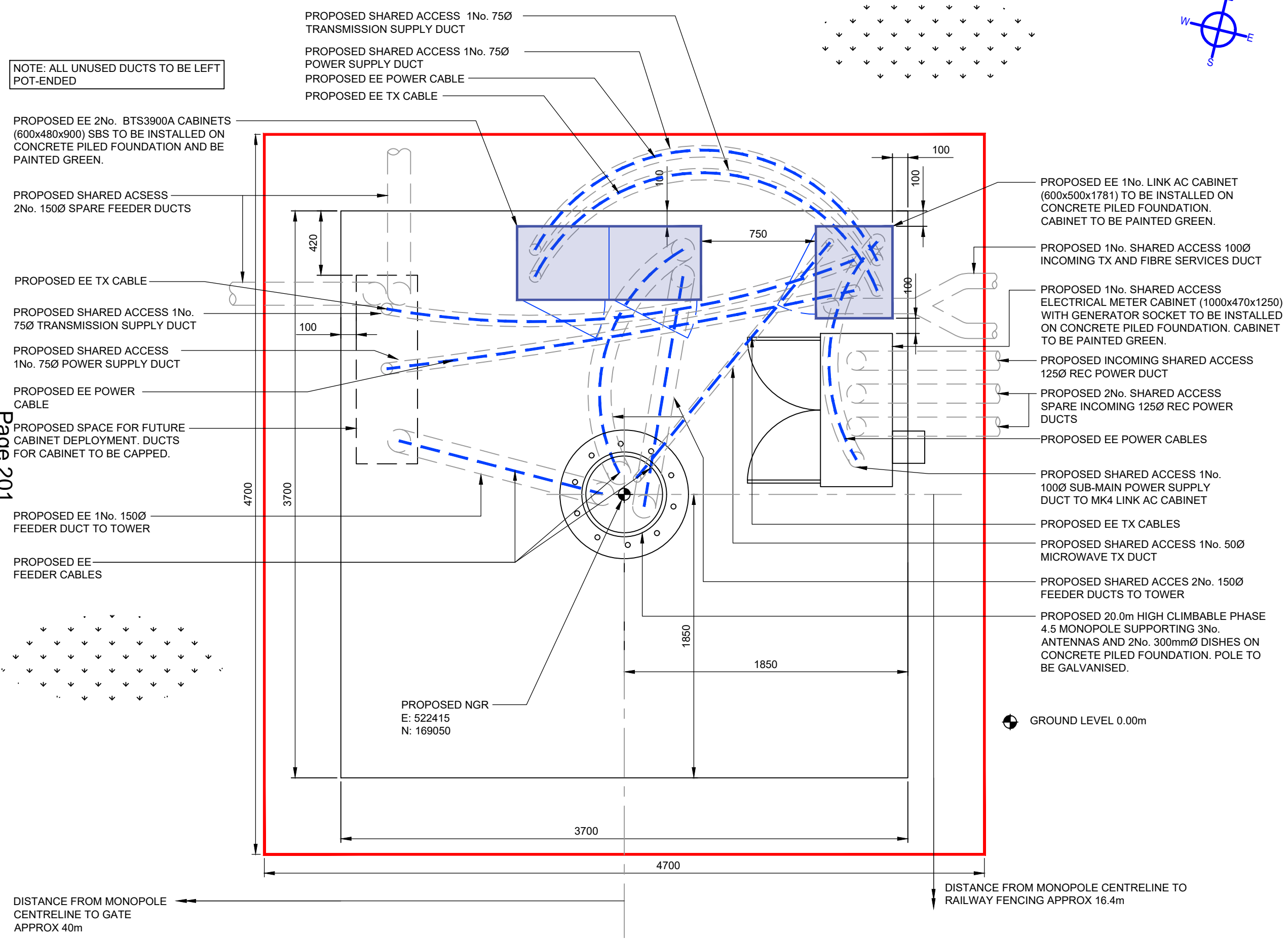

Page 201

PROPOSED EQUIPMENT LAYOUT (SCALE 1:25)

REV	ISSUE	DATE	DRN	APP
C	LEGAL UPDATE	08.08.19	LN	MH
B	GENERAL AMENDMENTS	20.02.19	GB	GD
A	FIRST ISSUE	17.08.18	GB	GD

THIS DRAWING IS THE COPYRIGHT OF NET COVERAGE SOLUTIONS LTD AND MAY NOT BE REPRODUCED OR DISCLOSED TO A THIRD PARTY IN ANY FORM WITHOUT WRITTEN PERMISSION

Shire

Head Office:
 The Chapel, Barnsley Hall Road,
 Bromsgrove, Worcestershire,
 B61 0SZ
 Tel: +44 (0) 1527 579 933
 Email: info@shire-uk.com

shared access



OPERATOR REF NO. TM:78203
OPERATOR: EE
DRAWING TITLE: PROPOSED EQUIPMENT LAYOUT
SCALE: 1:25
SITE NO. 78203
SITE NAME: RAYNES PARK SPORTS GROUND
SITE ADDRESS: TAUNTON AVENUE RAYNES PARK WEST WIMBLEDON LONDON SW20 0BH
OS GRID REFERENCE: 522415/169050
DRAWN: GB CHK: JL APP: GD
DATE: 17.08.18

SITE NO.	OPERATOR	DRG NO.	REVISION
78203	- EE -	04 -	C

ORIGINAL DRAWING SIZE: A3

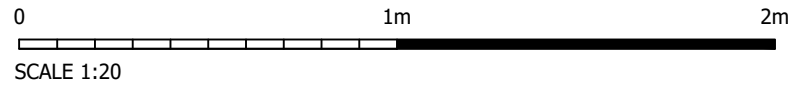
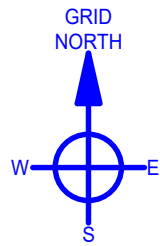

INFRASTRUCTURE KEY:

	OPERATOR INSTALLATION
	SHARED ACCESS INFRASTRUCTURE

GENERAL NOTES:
 1.1) USE WRITTEN DIMENSIONS ONLY
 1.2) ALL DIMENSIONS ARE IN MM UNLESS SPECIFIED
 1.3) ASSUME ALL SITE DETAILS ARE EXISTING UNLESS SPECIFIED

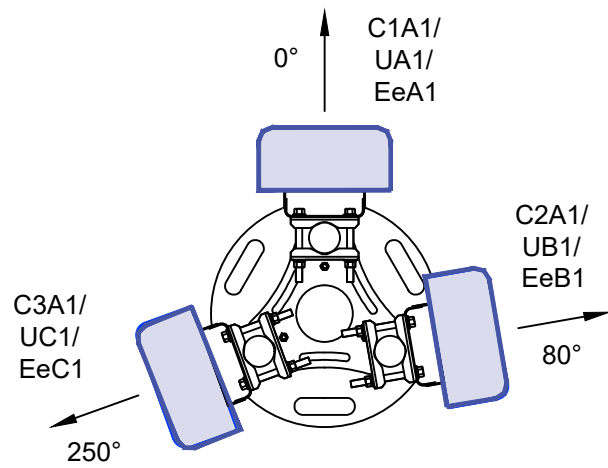

PROPOSED ANTENNA PLAN (SCALE 1:20)

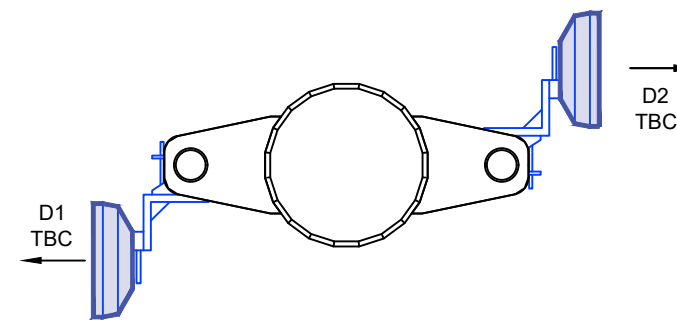

PROPOSED DISH PLAN (SCALE 1:20)

REV	ISSUE	DATE	DRN	APP
C	LEGAL UPDATE	08.08.19	LN	MH
B	GENERAL AMENDMENTS	20.02.19	GB	GD
A	FIRST ISSUE	17.08.18	GB	GD

© THIS DRAWING IS THE COPYRIGHT OF NET COVERAGE SOLUTIONS LTD AND MAY NOT BE REPRODUCED OR DISCLOSED TO A THIRD PARTY IN ANY FORM WITHOUT WRITTEN PERMISSION

Shire
 Head Office:
 The Chapel, Barnsley Hall Road,
 Bromsgrove, Worcestershire,
 B61 0SZ
 Tel: +44 (0) 1527 579 933
 Email: info@shire-uk.com

shared access



OPERATOR REF NO. TM:78203
OPERATOR: EE
DRAWING TITLE: PROPOSED ANTENNA AND DISH LAYOUT
SCALE: 1:20
SITE NO. 78203
SITE NAME: RAYNES PARK SPORTS GROUND
SITE ADDRESS: TAUNTON AVENUE RAYNES PARK WEST WIMBLEDON LONDON SW20 0BH

OS GRID REFERENCE: 522415/169050		
DRAWN: GB	CHK: JL	APP: GD
DATE: 17.08.18		

SITE NO.	OPERATOR	DRG NO.	REVISION
78203	- EE -	05 -	C

ORIGINAL DRAWING SIZE: A3