

Scale Bar - 100mm @ A3

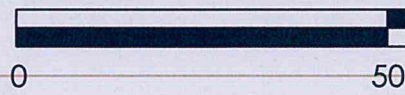

EMERGENCY FITTINGS KEY

NOTE: ALL EMERGENCY LIGHT FITTINGS AND SIGNAGE TO COMPLY WITH CURRENT REGULATIONS AND LOCAL FIRE OFFICER REQUIREMENTS.

- ILLUMINATED FIRE EXIT SIGN WITH ELECTRICAL MAINTAINED BATTERY PACK
- EMERGENCY LIGHT FITTING WITH ELECTRICAL MAINTAINED BATTERY PACK
- BREAK GLASS CALL POINTS
- GREEN BREAK GLASS TO OVERRIDE SECURITY DEVICE ON DOOR
- HEAT DETECTOR WITH INTEGRAL SOUNDER & VISUAL INDICATOR
- SMOKE DETECTOR WITH INTEGRAL SOUNDER & VISUAL INDICATOR
- FIRE EXTINGUISHER (WATER)
- FIRE EXTINGUISHER (CO₂)
- FIRE ALARM PANEL

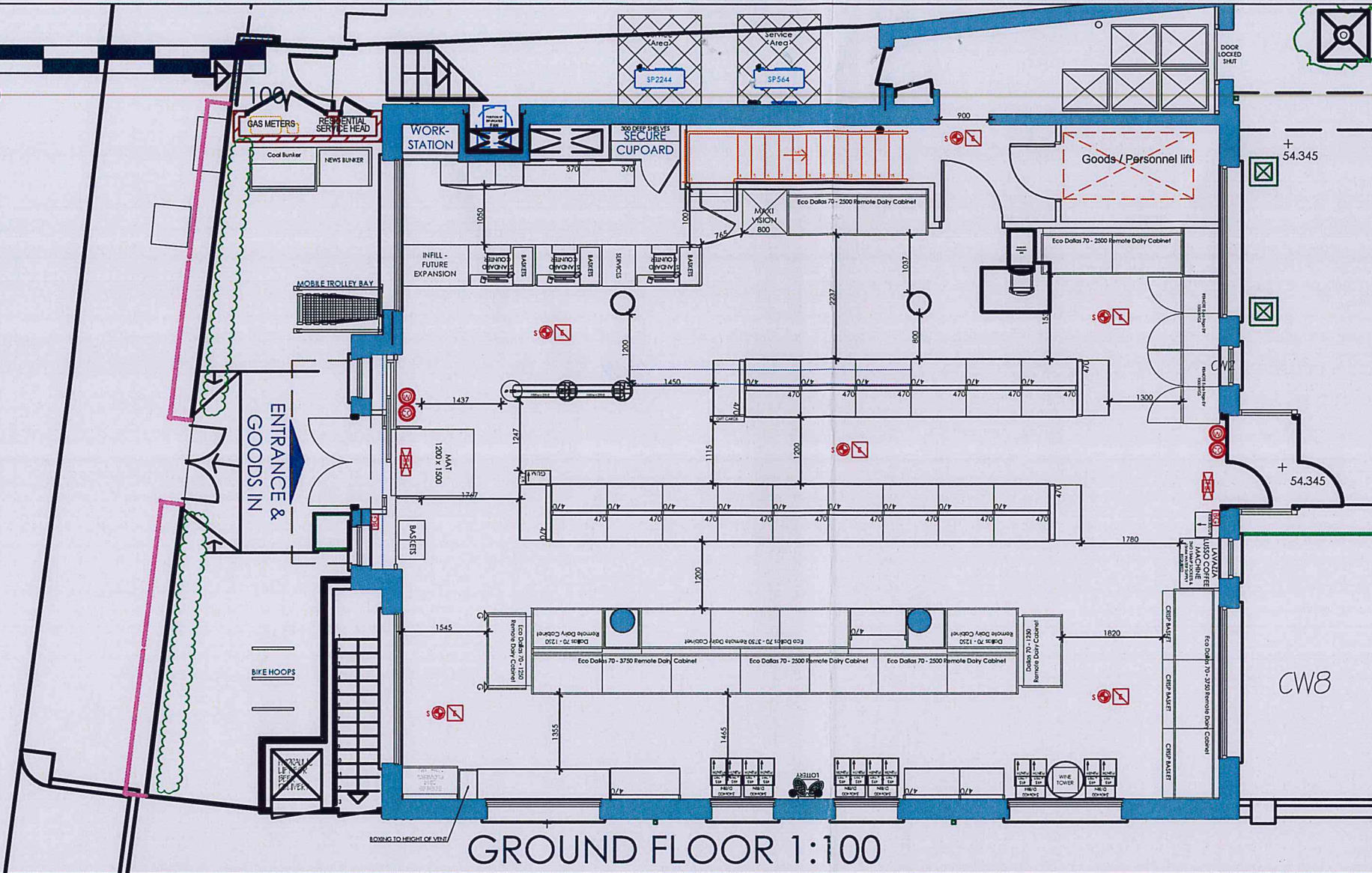

GROUND FLOOR 1:100

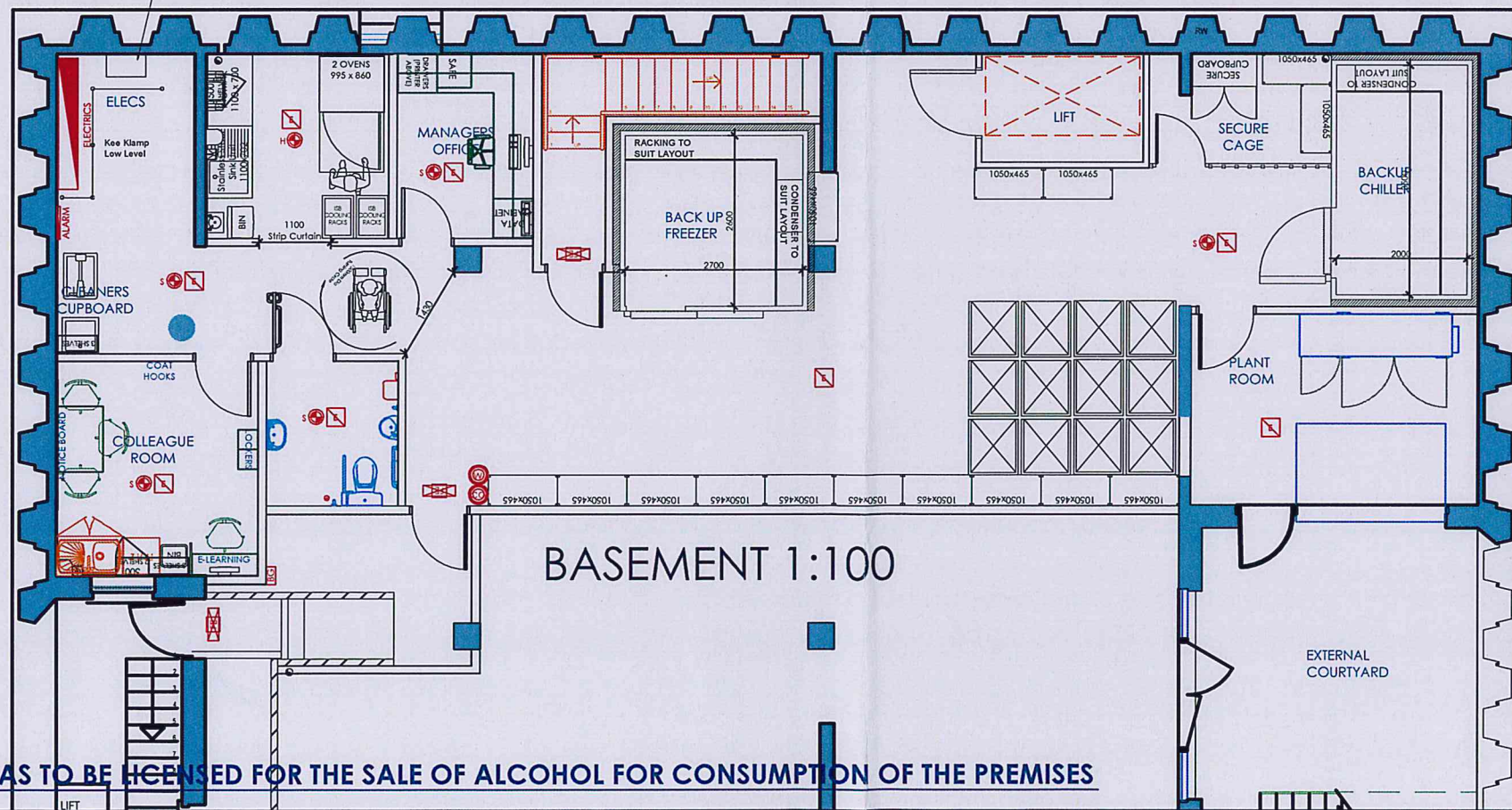

BASEMENT 1:100

ALL AREAS TO BE LICENCED FOR THE SALE OF ALCOHOL FOR CONSUMPTION OF THE PREMISES

THIS DRAWING IS THE COPYRIGHT OF THE SOUTHERN CO-OPERATIVE AND MAY NOT BE COPIED, ALTERED OR REPRODUCED IN ANY FORM, OR PASSED TO A THIRD PARTY WITHOUT THE WRITTEN CONSENT OF THE SOUTHERN CO-OPERATIVE.

DO NOT SCALE FROM THIS DRAWING, EXCEPT FOR PLANNING PURPOSES. USE FIGURED DIMENSIONS ONLY.

DIMENSIONS SHOULD BE CHECKED AND VERIFIED ON SITE AND ANY DISCREPANCIES SHOULD BE REPORTED TO THE DESIGNER.

IF IN DOUBT ASK FOR CONFIRMATION.

AREAS	M ²	FT ²
SALES	161	1733
BOH	146	1571
GROSS	420	4520
FIRST	NA	NA
SUB-LET	NA	NA
MOTHBALLED	73	785

REVISIONS

REV.	DESCRIPTION	DRAWN	CHKD.	DATE

ISSUED FOR

LICENCE

The Southern Co-operative

Retail and Business Development
 1000 Lakeside, Western Road, Portsmouth, PO6 3FE
 T: 023 9222 2500 | F: 023 9222 2650
 E: sarahlydford@southerncoops.co.uk

DRAWING APPROVAL	SIGNATURE	DATE
DRAWING APPROVAL	SIGNATURE	DATE
DRAWING APPROVAL	SIGNATURE	DATE

PROJECT
 83 RIDGEWAY
 WIMBLEDON
 LONDON
 SW19 4ST

DRAWING TITLE
 LICENCE LAYOUT

DRAWING SCALE	SHEET SIZE	SHEET No.	DRAWN	CHKD	DATE
1:100	A3	1 of 1	SL		04-05-2016

DRAWING NUMBER

16-XXX-400

REVISION

-

This page is intentionally left blank