

Note: The Wimbledon Stadium Development shown on contract for the Wimbledon Stadium Development is shown for context for the proposed development. The proposed development is shown in grey. Masterplan designed by Sheppard Robson for Galliard Homes.

Rev: 011 Date: 10.05.16 Dwg: SN CHK: GR
 Rev: 010 Date: 05.05.16 Dwg: SN CHK: GR
 Rev: 009 Date: 05.05.16 Dwg: SN CHK: GR
 Context Information as Requested by Local Authority

Do not build off the drawing
 Report all errors and omissions to the Architect
 Post date: 18/05/16 12:30:21

Client:
Volante Limited

Project:
46-76 Summerstown, SW17

Title:
Context Plan 2nd Floor

Drawing status:
Planning

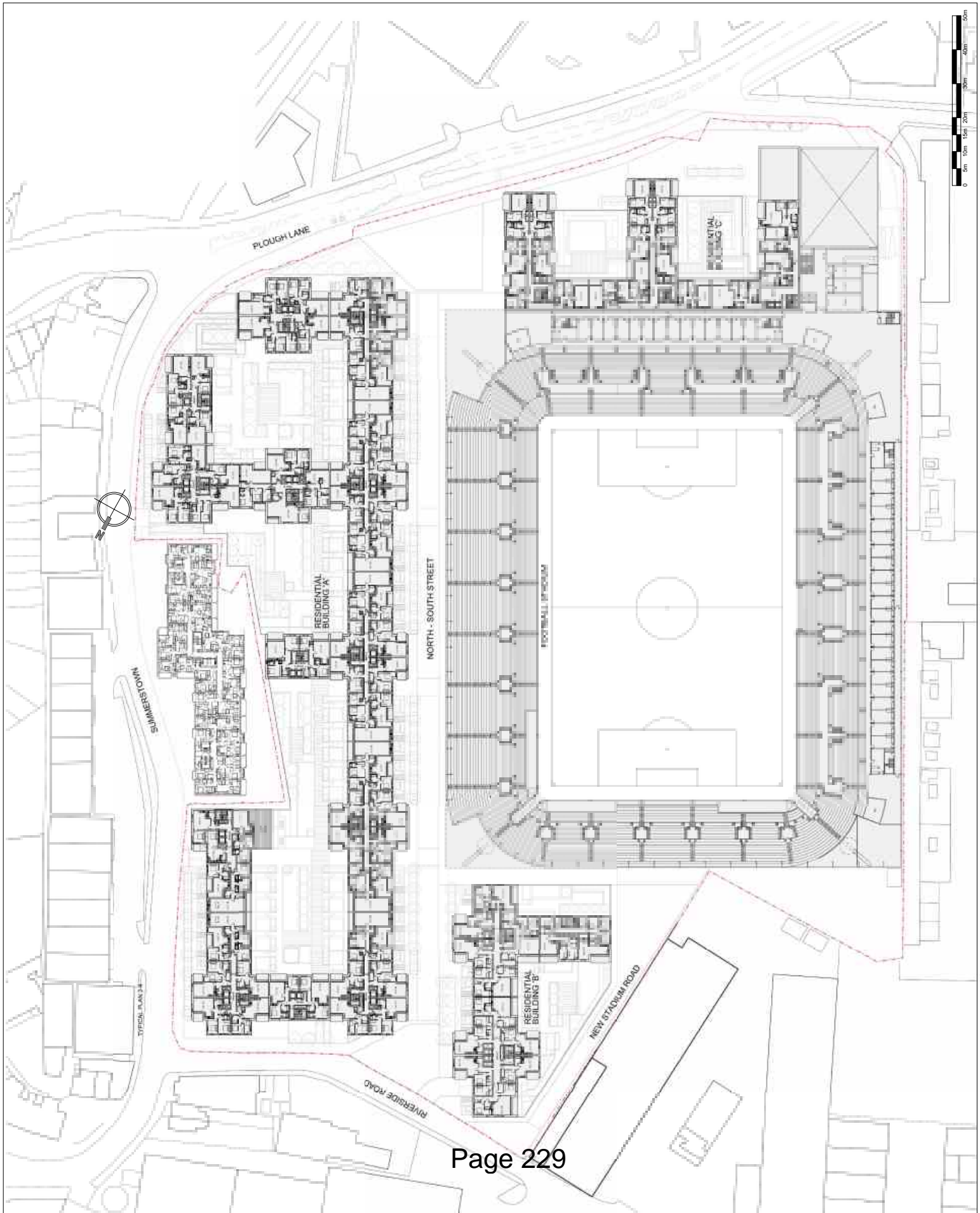

This page is intentionally left blank